

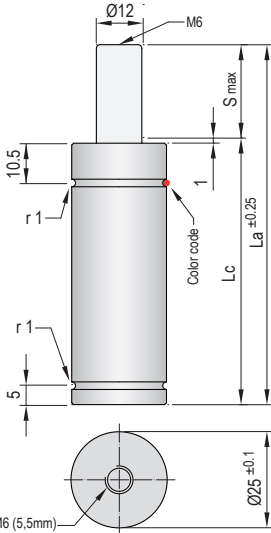

VDI SAFETY



Gas charging M6 (5,5mm)
TPFV3 valve
M6-C adapter

i Pressure medium **Nitrogen (N₂)**

Max. charging pressure	175 Bar
Min. charging pressure	25 Bar
Rod seal area	1,13 cm ²
Operating temperature	0°C - 80°C
Force increase by temperature	0,33 %/°C
Max. stem speed	1,6 m/s
Maintenance kit	Kit A25



Maximum strokes / minute (at 20°C)

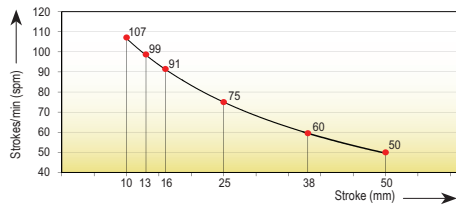

Code	Smax mm	La mm	Lc mm	V l	Kg
TPA 25x10	10	65	55	0,006	0,14
TPA 25x13	12,7	70,4	57,7	0,007	0,14
TPA 25x16	16	77	61	0,008	0,15
TPA 25x25	25	95	70	0,012	0,17
TPA 25x38	38	121,2	83,2	0,017	0,19
TPA 25x50	50	145	95	0,021	0,21

Color code	Fa daN	90% F daN	P Bar
GR (Green)	50 (±5)	≈ 70	45
BL (Blue)	100 (±10)	≈ 135	90
RD (Red)	150 (±15)	≈ 205	135
YW (Yellow)	200 (±20)	≈ 265	175
(Other forces)	28 - 200	≈ 40 - 277	25 - 175

The black color code denotes a different pressure from that which the customer could choose when ordering between the minimum charging pressure and the maximum charging pressure. If not otherwise specified, the gas spring will be supplied in the yellow code version (YW).

How to order

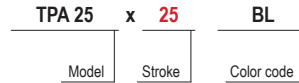

Force/stroke ratio

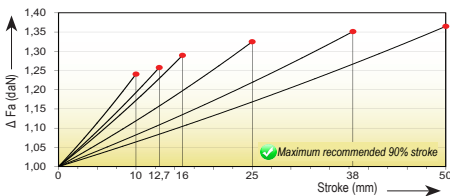

Initial force/charging pressure ratio

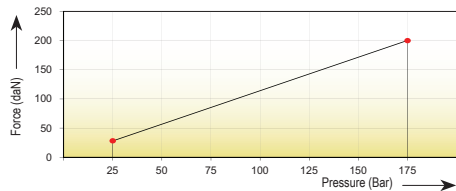

Assembly possibilities



Follow guidelines
Page 287



DROP-IN



SCREWS

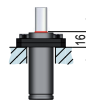

FS 25/1 · FS 25/2



FS 25/1 · FS 25/2

TPA
TPG

TPCT

TPSL

STOP
CYLINDER

STOP
CYLINDER

TPSR

TPSR5

TPNS

TPHT

